

Auto Crete RLC

Residential Light Commercial

Foundation Plan

Total Station Point Layout

Concrete & Rebar Takeoff

Aluminum Form Layout

SteelPly Form Layout

Radius Form Layout

Form A Drain Layout

EZ Footing Forming Layout

Proform HD

Call For An Online Demonstration

GDB Software, Inc.

800-845-6642

www.gdbsoftware.com

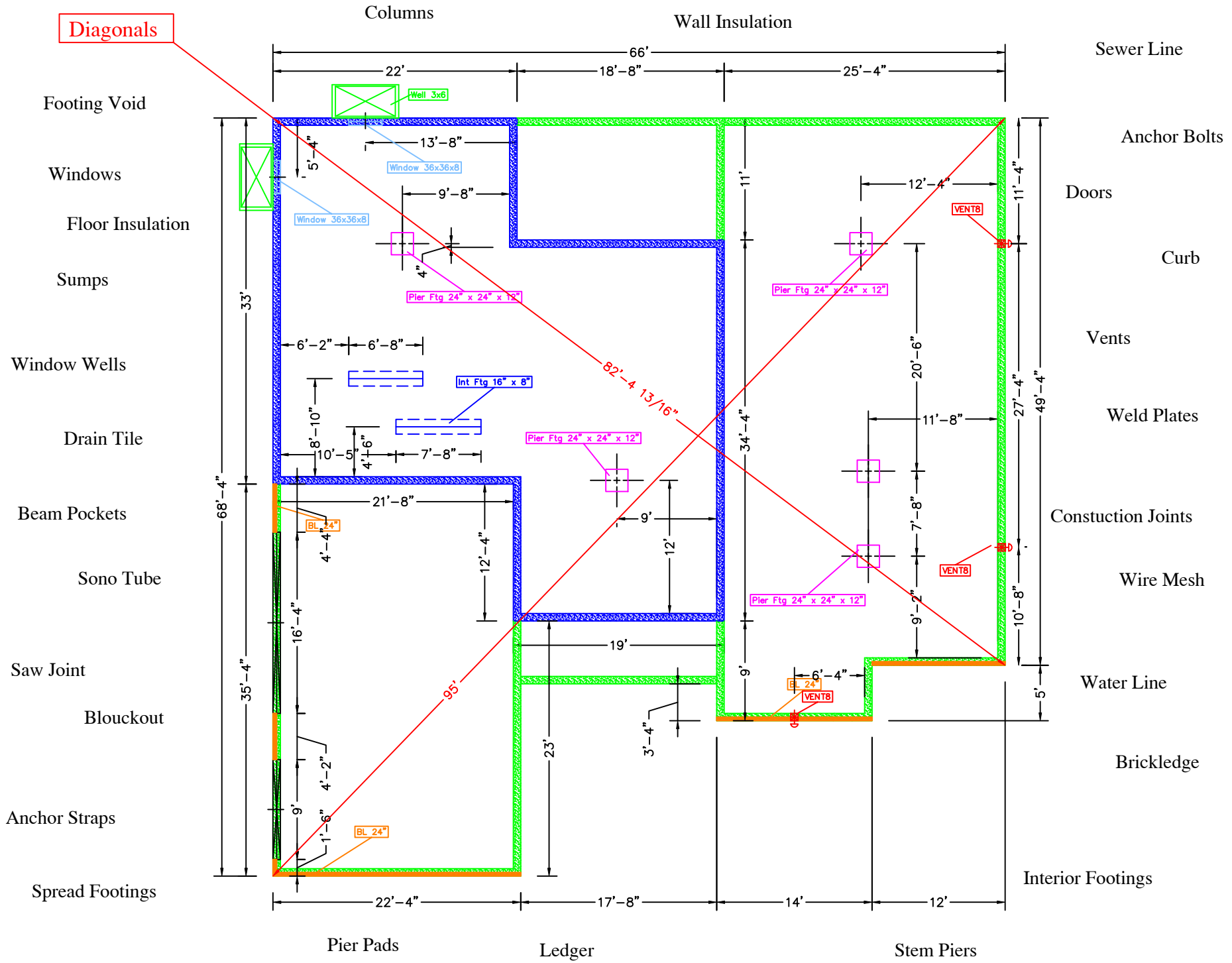

Foundation Plan

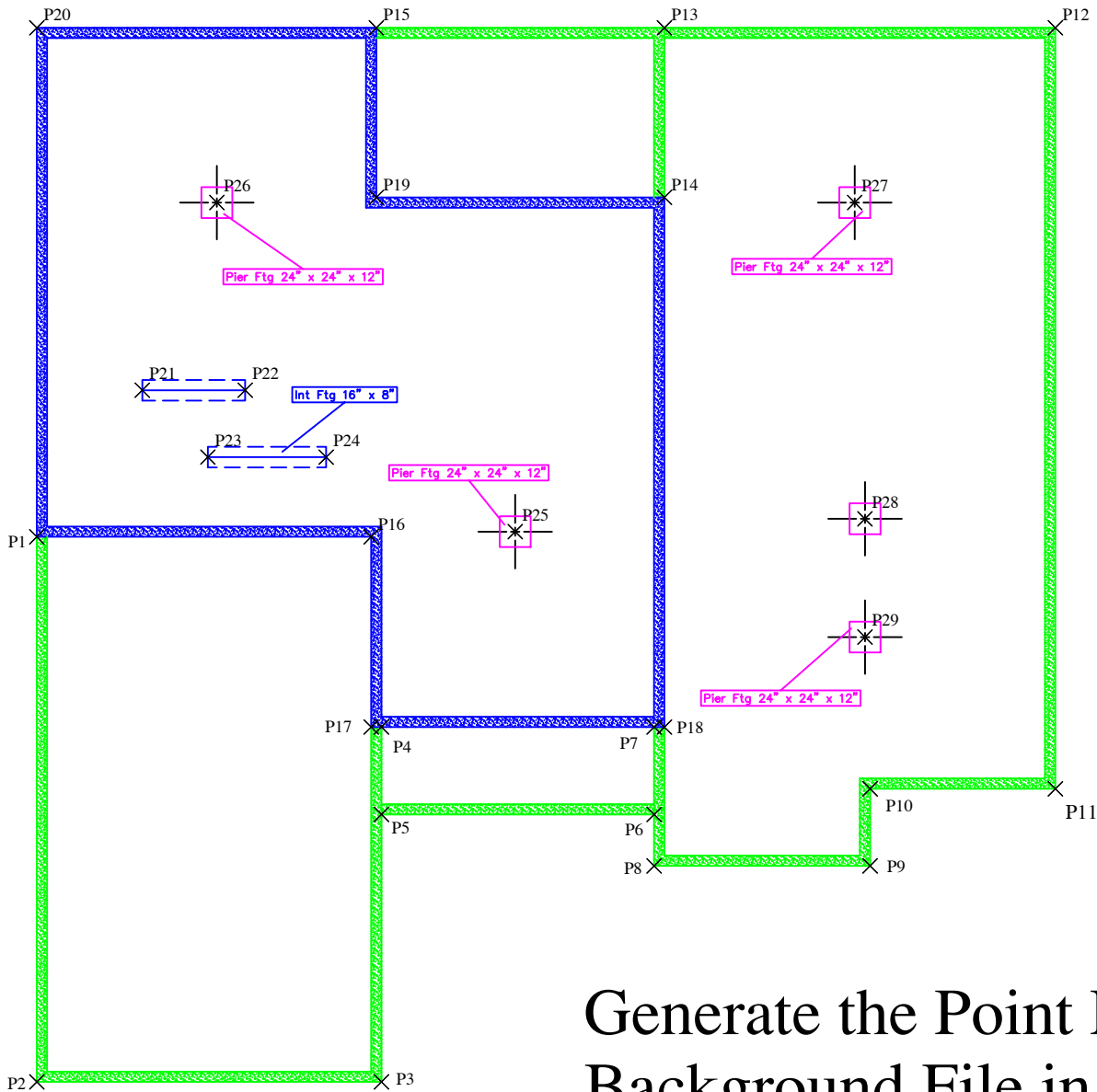

Point	Northing	Easting	Deg Min Sec	Distance
Walls, Piers				
P1	1043.424	1018.224	22 45 58	47.093
P2	1008.091	1018.224	66 3 39	19.939
P3	1008.091	1040.557	78 43 6	41.356
P4	1031.091	1040.557	52 31 36	51.103
P5	1025.424	1040.557	57 55 4	47.867
P6	1025.424	1058.224	66 24 40	63.532
P7	1031.091	1058.224	61 53 54	66.005
P8	1022.091	1058.224	69 13 22	62.273
P9	1022.091	1072.224	72 59 35	75.526
P10	1027.091	1072.224	69 26 22	77.137
P11	1027.091	1084.224	72 10 11	88.473
P12	1076.424	1084.224	47 46 47	113.729
P13	1076.424	1058.890	37 37 1	96.481
P14	1065.424	1058.890	41 59 29	88.025
P15	1076.424	1040.224	27 45 32	86.363
P16	1043.424	1039.890	42 34 17	58.965
P17	1031.091	1039.890	52 4 2	50.575
P18	1031.091	1058.890	62 10 7	66.593
P19	1065.424	1040.224	31 35 2	76.800
P20	1076.424	1018.224	13 24 43	78.567
P21	1052.924	1025.057	25 20 7	58.556
P22	1052.924	1031.724	30 56 21	61.703
P23	1048.591	1029.307	31 5 45	56.744
P24	1048.591	1036.974	37 16 6	61.058
P25	1043.757	1049.224	48 21 53	65.861
P26	1065.091	1029.890	24 39 54	71.625
P27	1065.091	1071.224	47 34 34	96.486
P28	1044.591	1071.890	58 11 25	84.596
P29	1036.924	1071.890	62 48 52	80.818

Generate the Point Layout and the Background File in Less than 1 Minute

Rebar Takeoff

Linear Feet	Pounds	Count
"4F28B",91.00	"4F28B",60.06	"4F28B",39,28" Vert 4' OC
"4F52B",238.33	"4F52B",157.30	"4F52B",55,52" Vert 4' OC
"4HF",476.87	"4HF",314.73	"4HF",24,1 - #4 Cont
"4HW",2233.60	"4HW",1474.18	"4HW",112,8 - #4Cont
"4W92S",299.00	"4W92S",197.34	"4W92S",39,92" Vert 4' OC

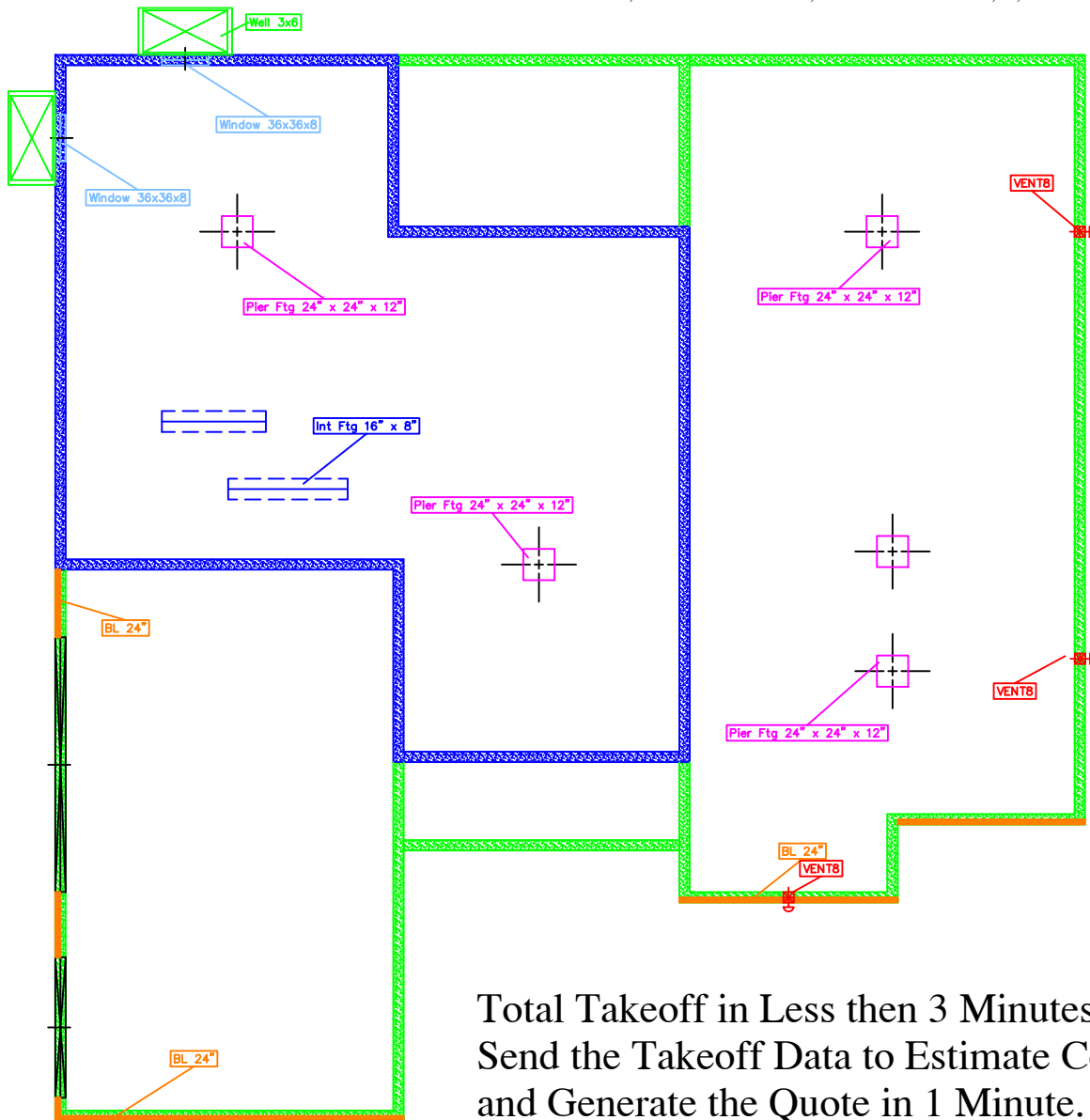

Total Takeoff in Less then 3 Minutes.
Send the Takeoff Data to Estimate Concrete
and Generate the Quote in 1 Minute.

Foundation Takeoff

"F20x8",242.7,9.99
 "W8x48",242.7,23.97
 "W8x96",172.0,33.98
 "P242412",5,Pier Ftg 24" x 24" x 12",0.74
 "BK8",25.3
 "BL24",58.0
 "WD36368",2
 "BWF168",14.3,,0.47
 "WELL3X6",2,Well 3x6
 "VENT8",3,VENT8
 "FOIL",46.2,4618.7
 "CORNERS",18
 "WATERPROFFING",1318.67

Flatwork Takeoff

"B4",1371,Basement Floor 4",16.93,172.00 lf.
 "P14",205,Patio 1 - 4",2.53,59.33 lf.
 "G4",781,Garage 4",9.64,115.33 lf.
 "E4",100,Entry 4",1.24,46.67 lf.
 "C4",1322,Crawl Space 4",16.33,160.67 lf.

Grading Takeoff

"Grading",3779 Sq. Ft. , 69.98 Tons

Pour Sequence

Pour #1

"F20x8",242.7,9.99
 "P242412",5,Pier Ftg 24" x 24" x 12",0.74
 "BWF168",14.3,,0.47
 Total: 12.50 Cu Yds
 Total: 262 Feet

Pour #2

"W8x48",242.7,23.97
 "W8x96",172.0,33.98
 Total: 60.00 Cu Yds
 Total: 415 Feet

Pour #3

"B4",1371,Basement Floor 4",16.93,172.00 lf.
 "G4",781,Garage 4",9.64,115.33 lf.
 Total: 27.50 Cu Yds

Pour #4

"P14",205,Patio 1 - 4",2.53,59.33 lf.
 "E4",100,Entry 4",1.24,46.67 lf.
 "C4",1322,Crawl Space 4",16.33,160.67 lf.
 Total: 21.00 Cu Yds

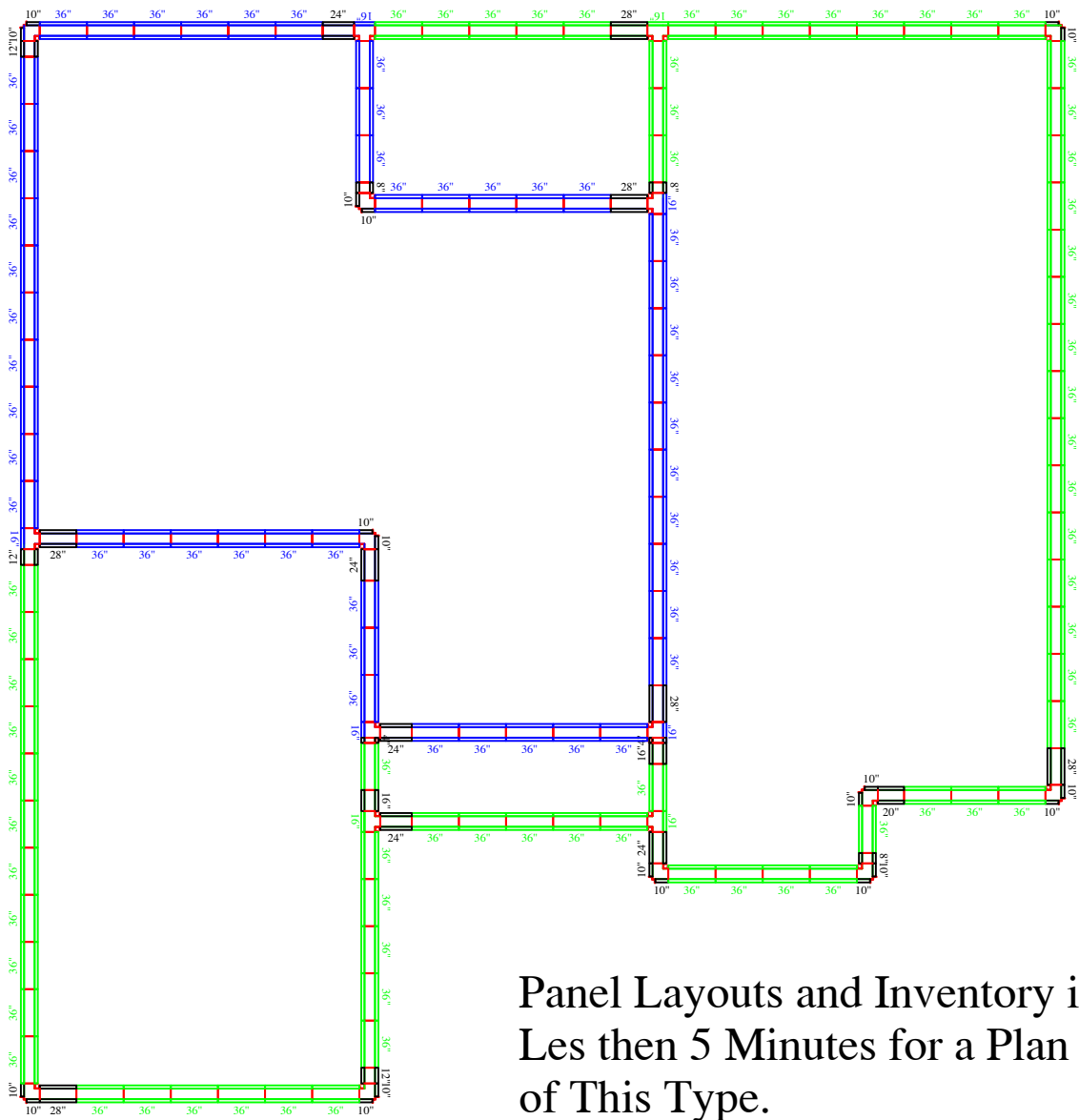

Panel Layouts and Inventory in
 Less than 5 Minutes for a Plan
 of This Type.

Panel Count		
Inside Corner		
7	4" X 4"	4'
3	4" X 4"	8'
Ties		
516	8"	
2" Wrap Outer Corners		
7	4'	
3	8'	
Panels		
4	4"	4'
4	8"	4'
14	10"	4'
4	12"	4'
7	16"	4'
2	20"	4'
4	24"	4'
6	28"	4'
136	36"	4'
2	8"	8'
6	10"	8'
2	12"	8'
5	16"	8'
6	24"	8'
6	28"	8'
96	36"	8'

Total Wedges: 3416

Total Panel Area: 4550.67 sqft

4 Aluminum Forming

SteelPly Forming

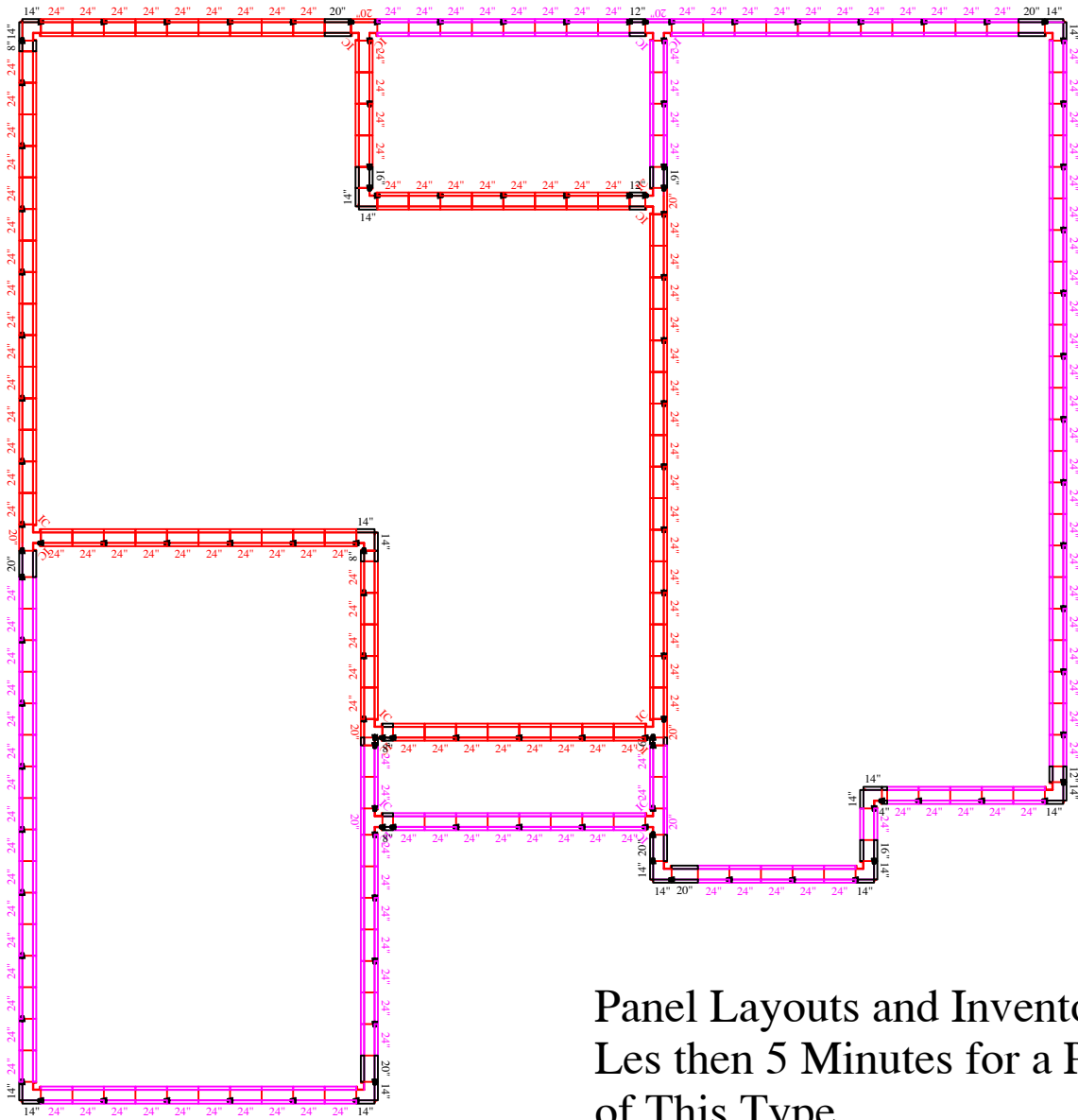

Panel Count		
Inside Corner		
7	6" X 6"	4'
3	6" X 6"	8'
Scaffold Brackets		
127		
Ties		
487	8"	
Turnbuckles		
127		
Waler Clamps		
127		
2" Wrap Outer Corners		
7	4'	
3	8'	
Panels		
2	4"	4'
4	6"	4'
2	8"	4'
4	12"	4'
14	14"	4'
4	16"	4'
13	20"	4'
204	24"	4'
6	8"	8'
2	12"	8'
6	14"	8'
2	16"	8'
7	20"	8'
150	24"	8'
Total Wedges:	508	
Total Panel Area:	4560 sqft	

Panel Layouts and Inventory in
Less than 5 Minutes for a Plan
of This Type.

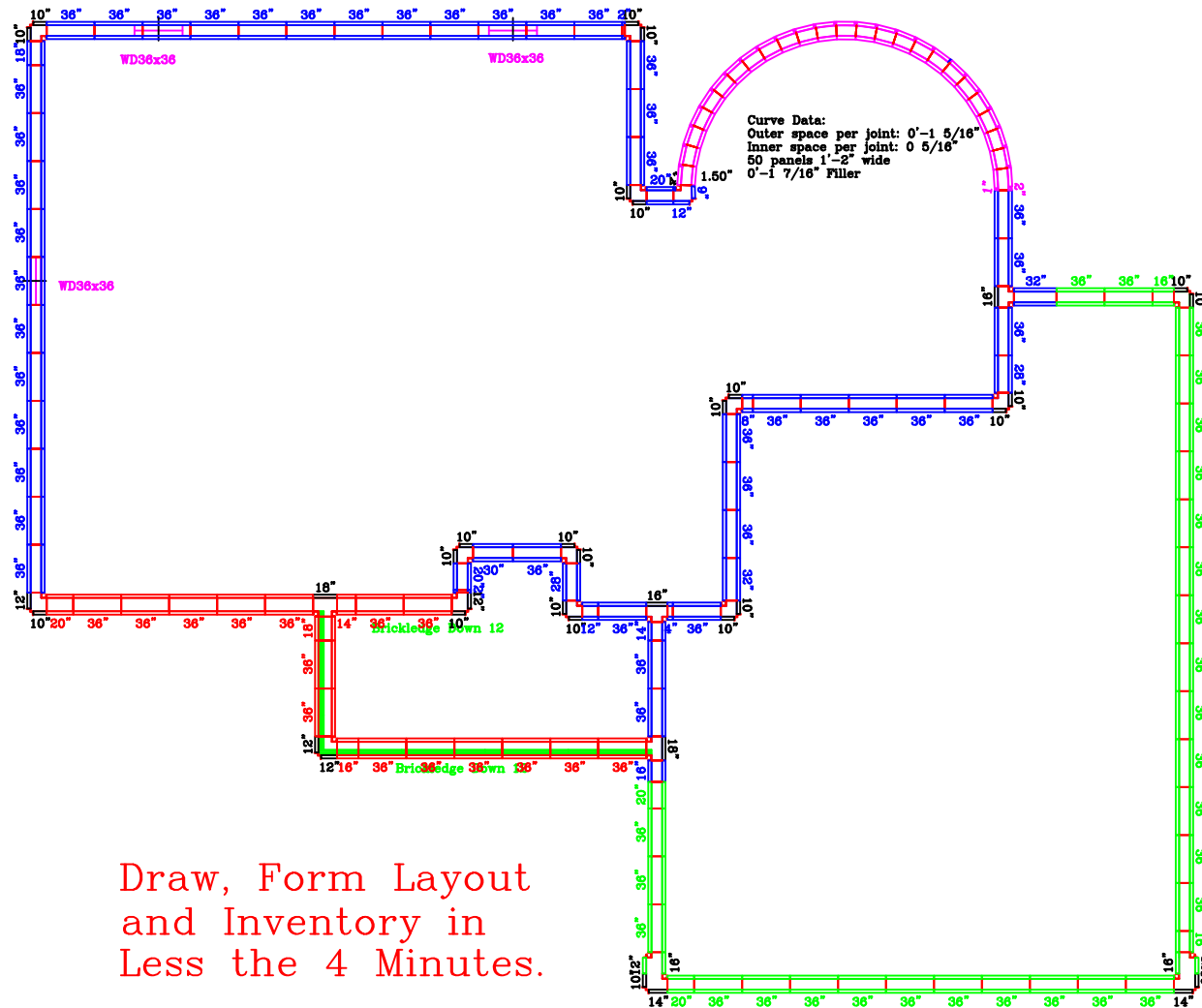

Draw, Form Layout
and Inventory in
Less the 4 Minutes.

Curve Data:
Outer space per joint: 0'-1 5/16"
Inner space per joint: 0 5/16"
50 panels 1'-2" wide
0'-1 7/16" Filler

Forming Inventory

Panel Count		
Inside Corner		
5	4" x 4"	4'
20	4" x 4"	8'
Scaffold Brackets		
6		
Ties		
562	8"	
115	10"	
Long Bolts		
20		
Outside Angle		
2		4'
2" Wrap Outer Corners		
3		4'
12		8'
1		8'
Hinged Inside Corner		
1	4"	8'
Panels		
4	10"	4'
2	12"	4'
2	14"	4'
6	16"	4'
4	20"	4'
56	36"	4'
1	1"	8'
24	1.31"	8'
1	1.50"	8'
5	2"	8'
2	4"	8'
2	8"	8'
1	9"	8'
20	10"	8'
7	12"	8'
54	14"	8'
6	16"	8'
6	18"	8'
6	20"	8'
4	28"	8'
4	30"	8'
4	32"	8'
114	36"	8'
Total Panel area: 4783.29 square feet		
Wedges 3412		

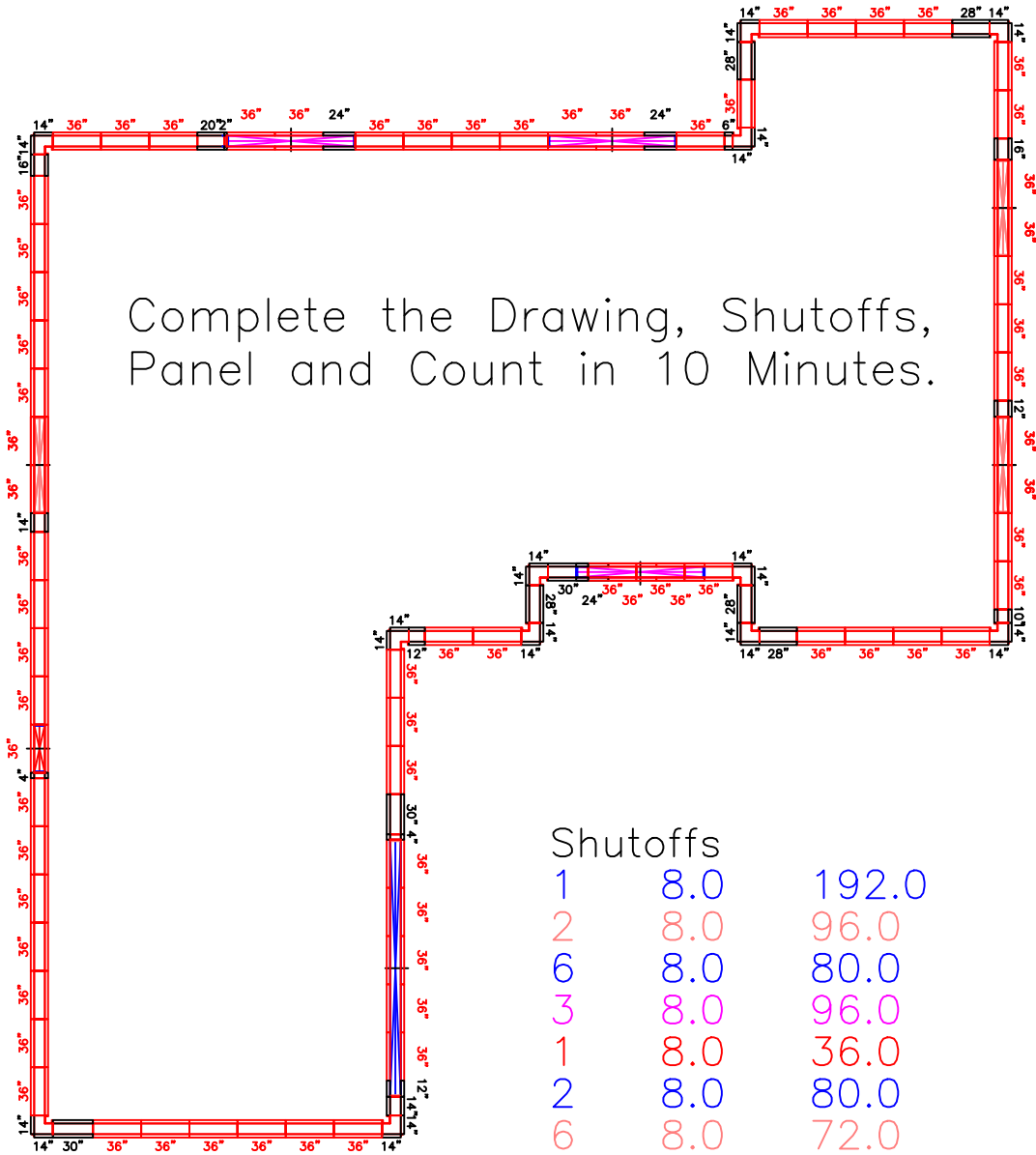

Complete the Drawing, Shutoffs, Panel and Count in 10 Minutes.

Shutoffs		
1	8.0	192.0
2	8.0	96.0
6	8.0	80.0
3	8.0	96.0
1	8.0	36.0
2	8.0	80.0
6	8.0	72.0
6	8.0	48.0

Panel Count		
12	6" x 6"	10'
558	8"	
12	Long Bolts	
12	Outside Angle	10'
Panels		
2	12"	2'
22	36"	2'
6	24"	40''
14	36"	40''
12	36"	4''
2	2"	10'
4	4"	10'
2	6"	10'
2	10"	10'
4	12"	10'
28	14"	10'
4	16"	10'
2	20"	10'
10	28"	10'
6	30"	10'
108	36"	10'

Total Panel area: 4700.00 square'

Above Ground

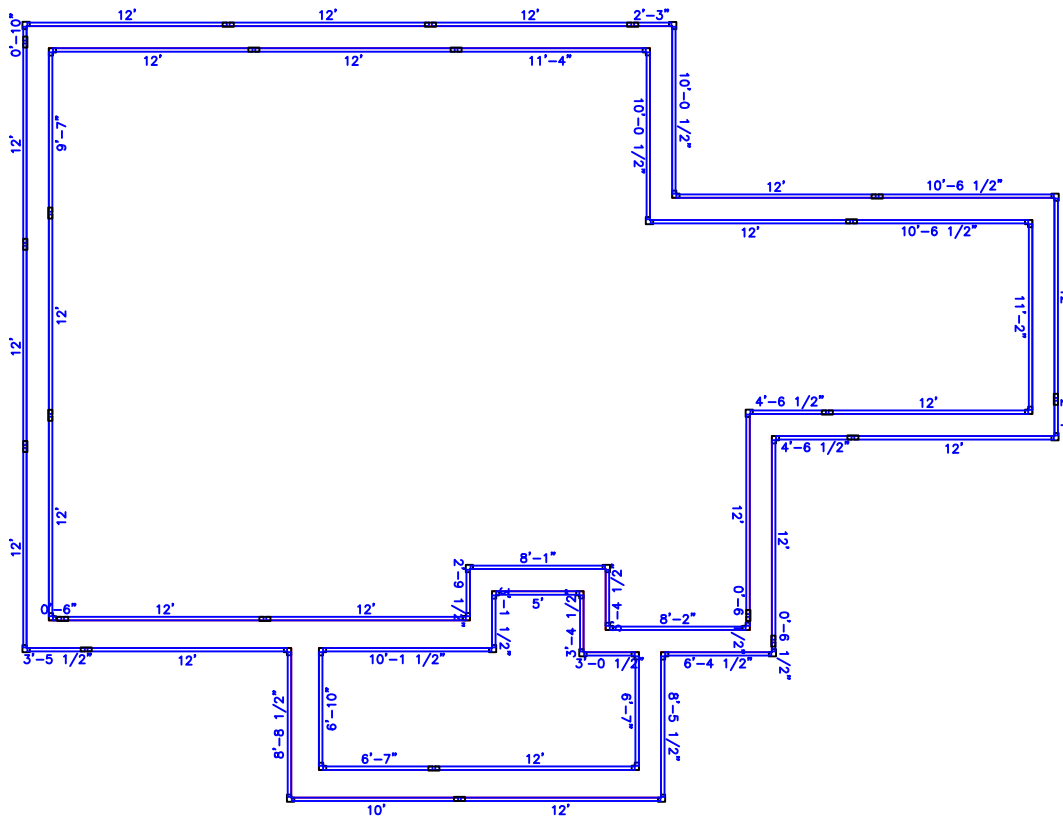

Takeoff

- "DRAIN", 457.2
- "FAD90", 32
- "FADCoupler", 22
- "FADCrossover", 76
- "FADStake", 114

Complete This Layout in Less then 2 Minutes.

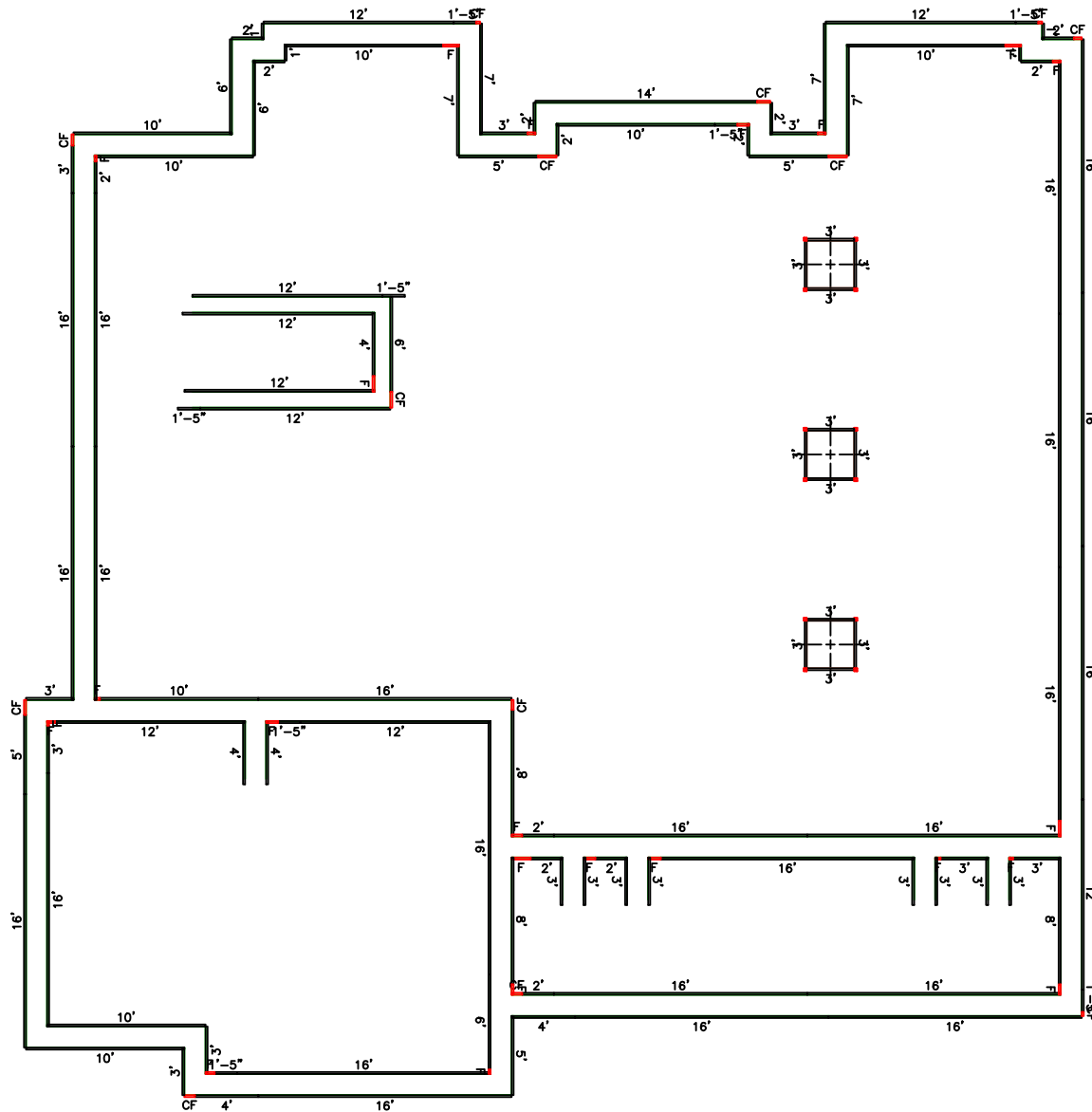

Forming Inventory	
1'	12
2'	13
3'	29
4'	5
5'	4
6'	4
7'	4
8'	3
10'	8
12'	9
14'	1
16'	23
DJ	12
CF	13
F	23
TIES 12"	5
TIES 16"	59

Draw the Footing and place in less than 5 minutes.

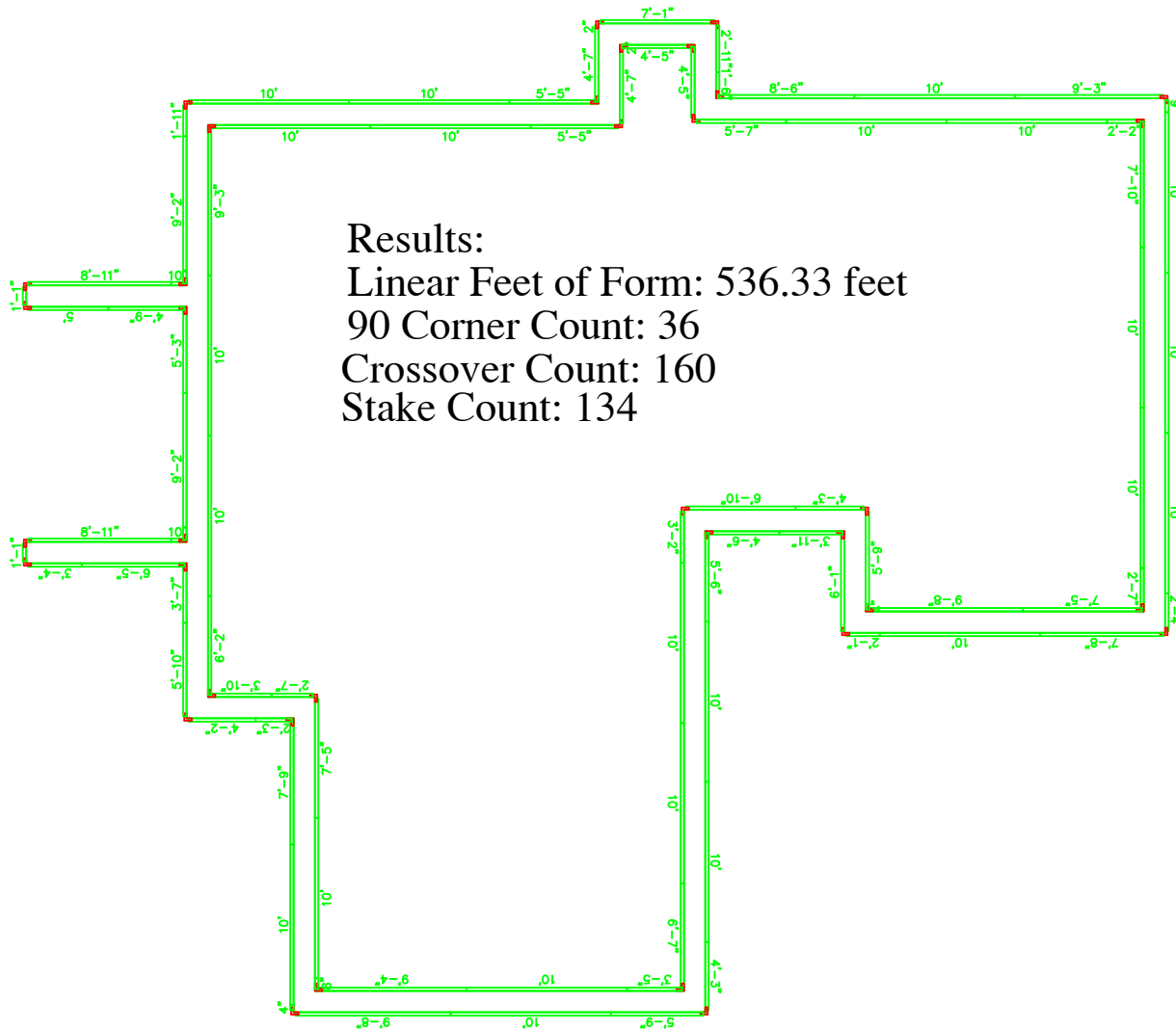

Results:
 Linear Feet of Form: 536.33 feet
 90 Corner Count: 36
 Crossover Count: 160
 Stake Count: 134

Draw the Footing and Place in Less than 5 minutes.